

IAT10.5Kb

CryptoAuthentication™ Memory Token



The power of memory. Secured.

The IAT10.5Kb CryptoAuthentication™ memory token utilizes Microchip's ATECC608A IC, part of their CryptoAuthentication family of high-security hardware authentication ICs. The IAT10.5Kb memory token takes the ATECC608A's security features and puts them into a physically robust portable memory device, enabling embedded applications, like:

- Secure storage/transfer of keys, certificates, passwords
- Secure credential with unique, read-only serial number
- Crypto Ignition Key (CIK)
- Device authentication (anti-counterfeit) with countdown limit use
- Secure Boot and Secure Download Firmware Update

The token's internal IC contains a 1208-byte (9664-bit) Data Zone of EEPROM memory that is divided into 16 slots. 8 slots are 36 bytes (288 bits), 7 slots are 72 bytes (576 bits) and one slot is 416 bytes (3328 bits). Each slot can be configured for read-only or read/write access in either clear or encrypted modes. There is also a 64-byte (512-bit) One Time Programmable (OTP) Zone. Data may be written until the zone is locked. Two monotonic counters can be used for limit-use applications. The IC also includes a unique 9-byte (72-bit) non-changeable serial number. The ATECC608A also features a random number generator, hardware support for asymmetric Elliptic Curve Cryptography (ECDH and ECDSA) and hardware support for symmetric algorithms SHA-256 and AES-128. The IC also incorporates security features to detect tampering and thwart attacks.

The memory token uses solid over-molded construction using a rugged composite that protects the internal IC from harsh environments. The token features redundant contacts so it can be inserted into the receptacle with either side up.

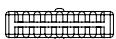
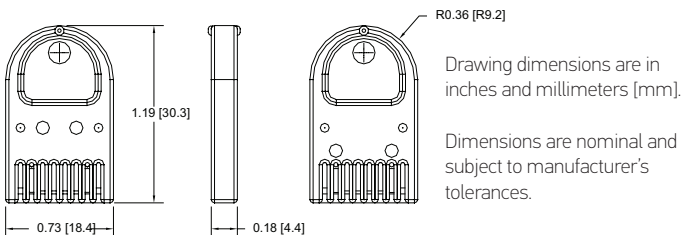

WARNING: Cancer and Reproductive Harm - www.P65Warnings.ca.gov

221-0214-000 Rev. B 6/20

View our full product line at www.datakey.com

ATEK Access Technologies
10025 Valley View Road, Ste. 190
Eden Prairie, MN 55344 U.S.A.

PH: 1.800.523.6996
FAX: 1.800.589.3705
+1.218.829.9797

www.atekaccess.com

MECHANICAL	
Contact Life	10,000 Insertion/Removal Cycles Min.
Contact Arrangement	Fully Redundant (Front:Back)
ELECTRICAL ¹	
Power, Active	6.6 mW Typical at 3.3 V
Power, Idle	2.64 mW Typical at 3.3 V
Voltage	2.0 to 5.5 V
ESD Protection	15 kV (air), 8 kV (contact) per MIL-STD-461G CS118
I ² C Device Address	Set in Configuration Register
ENVIRONMENTAL	
Storage Temperature	-40°C to +100°C
Operating Temperature	-40°C to +85°C
Relative Humidity	5% to 95% (non-condensing)
MEMORY ¹	
IC Mfg./Model	Microchip ATECC608A
Data Zone	9.7 Kb (9,664 bits) 16 Read-Only or Read/Write Slots
OTP Zone	0.5 Kb (512 bits) One Time Programmable Memory
Read Cycles	Unlimited
Write/Erase Cycles	400,000 Cycles Minimum
Data Life (Storage)	10 Years Minimum at 55°C
MATING COMPONENT(S)	
Panel-Mount Receptacle	SR4210, SR4310, SR4410, SR4310xL, SR4410xL
PCB Mount Receptacle	SR4210PCB/SM, SR4220PCB/SM, SR4230PCB/SM
Programmer/Dev Kit	Tokens Work With Microchip's CryptoAuthentication SOIC XPRO Starter Kit (p/n: DM320109)
ORDERING INFORMATION ²	
IAT10.5Kb	611-0234-00xA
SR4210PCB Receptacle XPRO Extension Board	607-0087-000A
SR4220VRT Receptacle XPRO Extension Board	607-0088-000A

1: Refer to ATECC608A CryptoAuthentication IC datasheet available at www.microchip.com.

See also I²C EEPROM Interface Specification available at www.datakey.com.

2: "x" indicates optional color number. "A" suffix on part number indicates RoHS compliance.

NOTES: Conforms with Directive 2011/65/EU of the European Parliament and of the Council of 8 June 2011, and as amended by Directive 2015/863/EU, on the restriction of the use of certain hazardous substances in electrical and electronic equipment.



CryptoAuthentication is a trademark of Microchip Technology Incorporated in the U.S.A. and other countries and is used under license.



Access the power of technology.